



THE mural

BY BEYOND

FLOOR PLANS

1 BEDROOM

TYPE A1



UNIT AREAS

INTERNAL AREA	674 - 688	SQ.FT
EXTERNAL AREA	73 - 99	SQ.FT
TOTAL AREA	749 - 787	SQ.FT

KEY SECTION



FLOOR 4



FLOOR 5 - 8

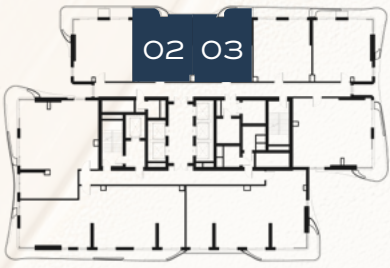

FLOOR 9 - 14, 16 - 30

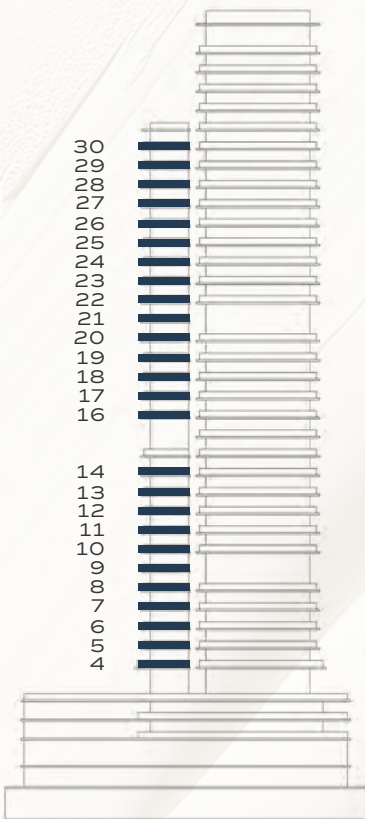

The renderings and visualisations in this brochure are for illustrative and marketing purposes only. While the information provided is accurate and reliable at the time of publication, it is important to note that only the information included in the final Sales and Purchase Agreement will carry legal significance.

1 BEDROOM

TYPE A2



UNIT AREAS

INTERNAL AREA	683	SQ.FT
EXTERNAL AREA	108 - 153	SQ.FT
TOTAL AREA	791 - 836	SQ.FT

KEY SECTION



The renderings and visualisations in this brochure are for illustrative and marketing purposes only. While the information provided is accurate and reliable at the time of publication, it is important to note that only the information included in the final Sales and Purchase Agreement will carry legal significance.

1 BEDROOM

TYPE B1 & B2



UNIT AREAS

INTERNAL AREA	693 - 701	SQ.FT
EXTERNAL AREA	196 - 329	SQ.FT
TOTAL AREA	893 - 1,022	SQ.FT

KEY SECTION

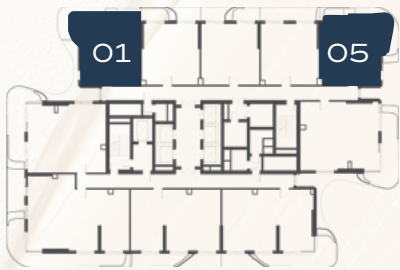

FLOOR 4



FLOOR 5 - 8

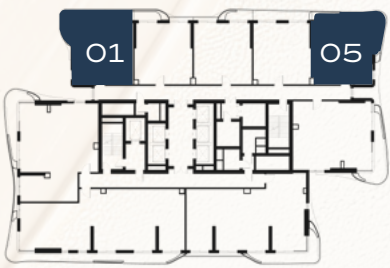

FLOOR 9 - 14, 16 - 30

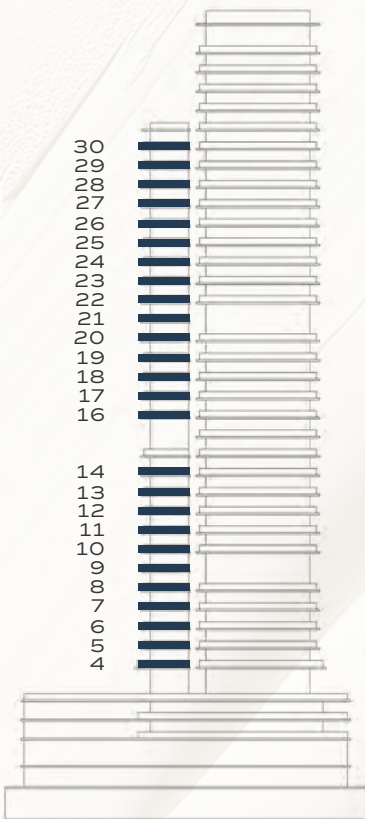

The renderings and visualisations in this brochure are for illustrative and marketing purposes only. While the information provided is accurate and reliable at the time of publication, it is important to note that only the information included in the final Sales and Purchase Agreement will carry legal significance.

2 BEDROOM

TYPE A



UNIT AREAS

INTERNAL AREA	1,034 - 1,047	SQ.FT
EXTERNAL AREA	216 - 349	SQ.FT
TOTAL AREA	1,255 - 1,387	SQ.FT

KEY SECTION

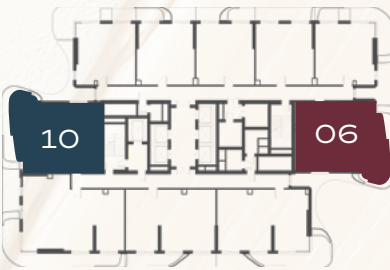

FLOOR 4

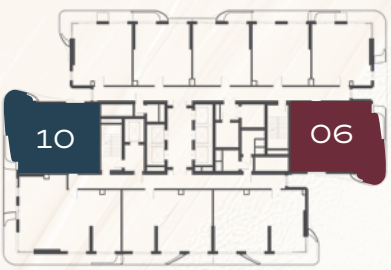

FLOOR 5 - 7

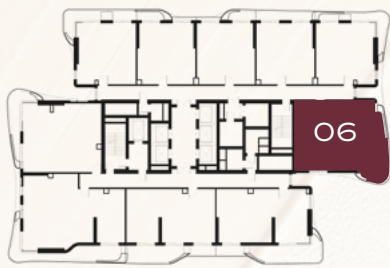

FLOOR 8, 9, 20, 21

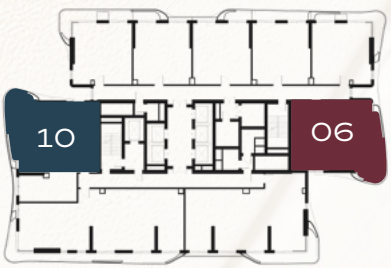

UNIT 06
FLOOR 10 - 14, 16 - 30
UNIT 10
FLOOR 10 - 14, 16 - 27

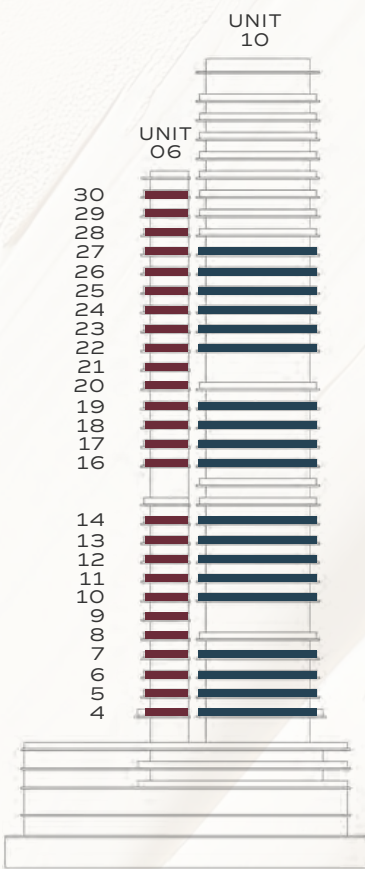

The renderings and visualisations in this brochure are for illustrative and marketing purposes only. While the information provided is accurate and reliable at the time of publication, it is important to note that only the information included in the final Sales and Purchase Agreement will carry legal significance.

2 BEDROOM

TYPE B



UNIT AREAS

INTERNAL AREA	1,320 - 1,322	SQ.FT
EXTERNAL AREA	315 - 496	SQ.FT
TOTAL AREA	1,636 - 1,816	SQ.FT

KEY SECTION



The renderings and visualisations in this brochure are for illustrative and marketing purposes only. While the information provided is accurate and reliable at the time of publication, it is important to note that only the information included in the final Sales and Purchase Agreement will carry legal significance.

2 BEDROOM

TYPE C1 & C2



UNIT AREAS

INTERNAL AREA	1,055 - 1,068	SQ.FT
EXTERNAL AREA	129 - 326	SQ.FT
TOTAL AREA	1,185 - 1,393	SQ.FT

KEY SECTION

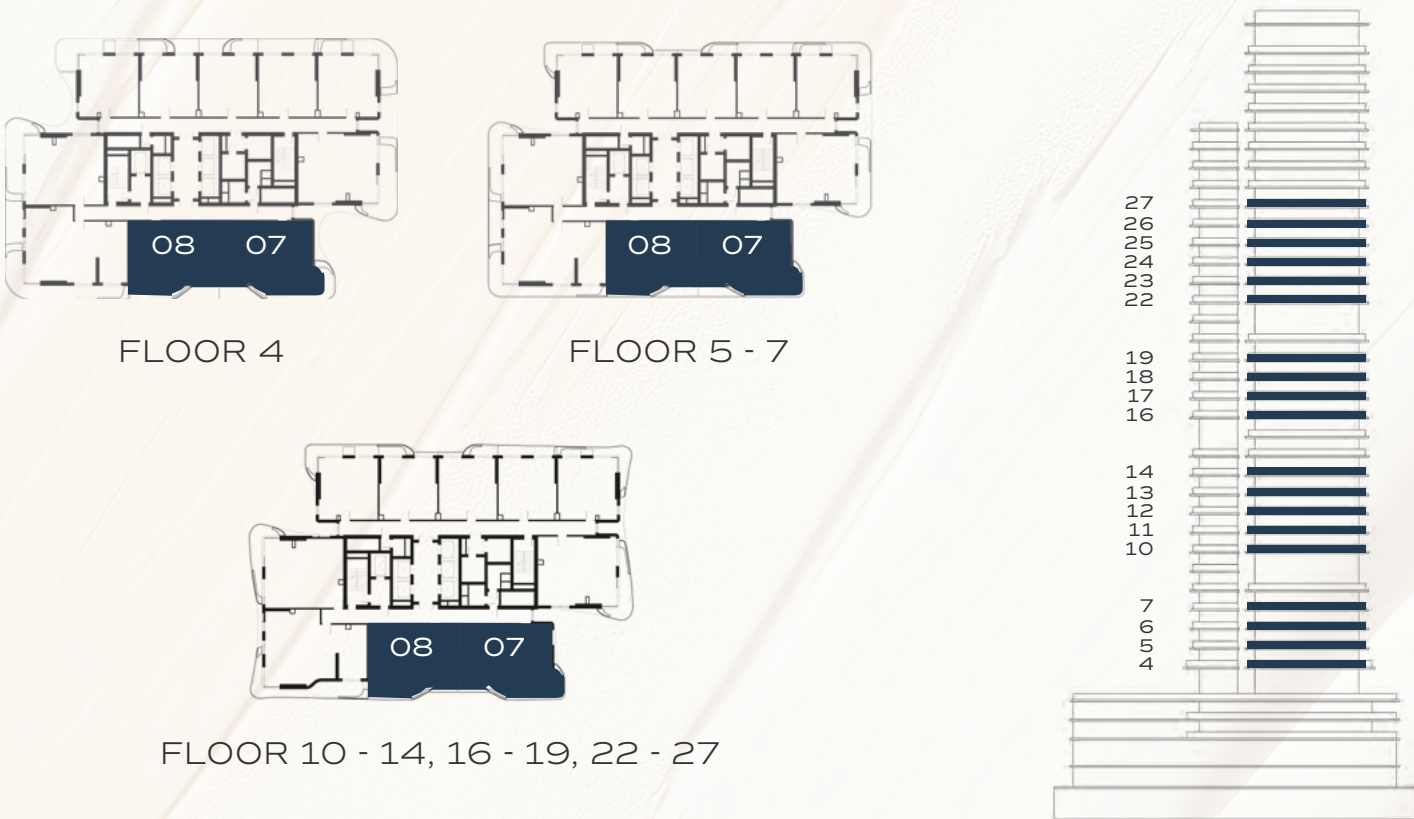

The renderings and visualisations in this brochure are for illustrative and marketing purposes only. While the information provided is accurate and reliable at the time of publication, it is important to note that only the information included in the final Sales and Purchase Agreement will carry legal significance.

3 BEDROOM

TYPE A



UNIT AREAS

INTERNAL AREA	1,354	SQ.FT
EXTERNAL AREA	209	SQ.FT
TOTAL AREA	1,563	SQ.FT

KEY SECTION

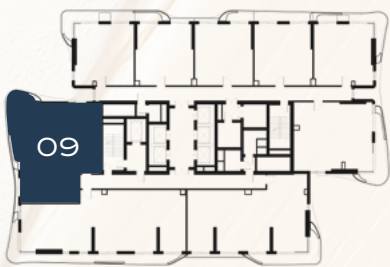

FLOOR 28 - 30



FLOOR 31 - 34
(EXECUTIVE)

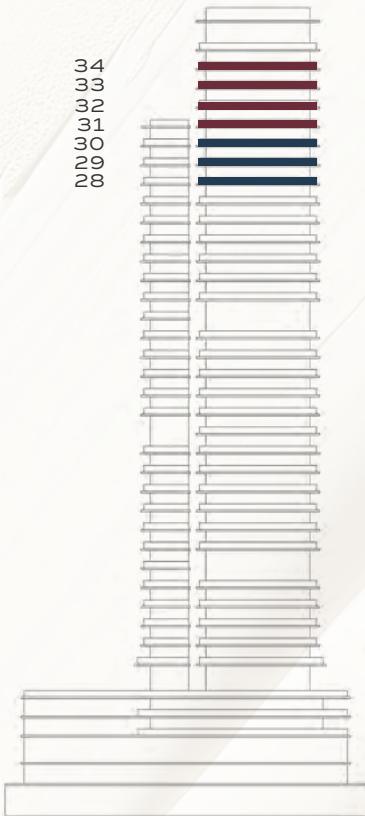

The renderings and visualisations in this brochure are for illustrative and marketing purposes only. While the information provided is accurate and reliable at the time of publication, it is important to note that only the information included in the final Sales and Purchase Agreement will carry legal significance.

3 BEDROOM

TYPE B



UNIT AREAS

INTERNAL AREA	1,759 - 1,760	SQ.FT
EXTERNAL AREA	436 - 438	SQ.FT
TOTAL AREA	2,196 - 2,198	SQ.FT

KEY SECTION



FLOOR 28 - 30



FLOOR 31 - 34
(EXECUTIVE)

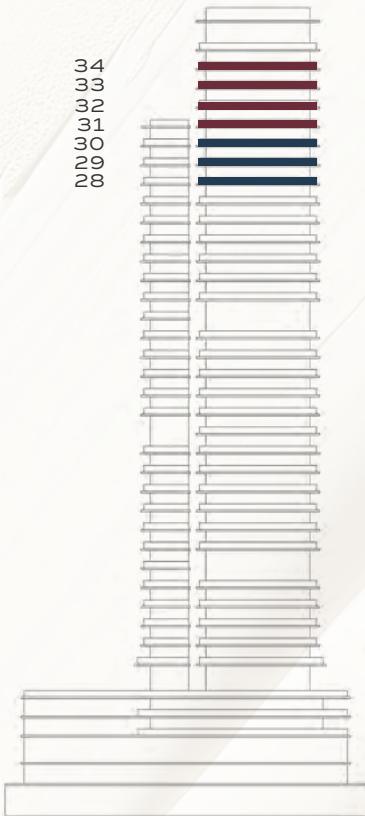

The renderings and visualisations in this brochure are for illustrative and marketing purposes only. While the information provided is accurate and reliable at the time of publication, it is important to note that only the information included in the final Sales and Purchase Agreement will carry legal significance.

3 BEDROOM

TYPE C



UNIT AREAS

INTERNAL AREA	1,521 - 1,526	SQ.FT
EXTERNAL AREA	222	SQ.FT
TOTAL AREA	1,743 - 1,748	SQ.FT

KEY SECTION



FLOOR 28 - 30



FLOOR 31 - 34
(EXECUTIVE)

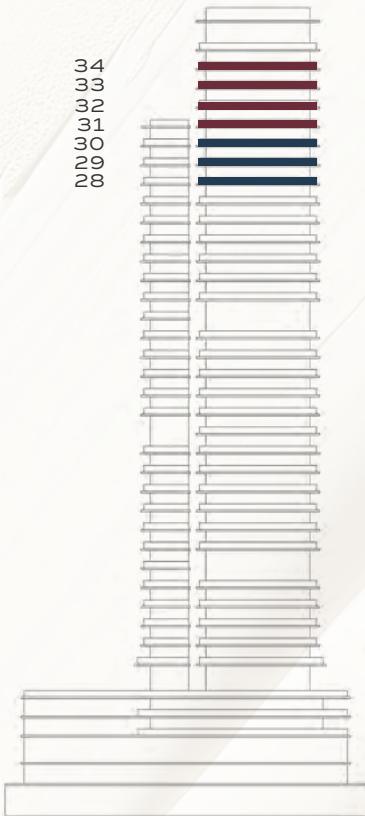

The renderings and visualisations in this brochure are for illustrative and marketing purposes only. While the information provided is accurate and reliable at the time of publication, it is important to note that only the information included in the final Sales and Purchase Agreement will carry legal significance.

3 BEDROOM - SIGNATURE COLLECTION

TYPE A



LOWER LEVEL



UPPER LEVEL

UNIT AREAS

INTERNAL AREA	1,924	SQ.FT
EXTERNAL AREA	209 - 242	SQ.FT
TOTAL AREA	2,133 - 2,166	SQ.FT

KEY SECTION

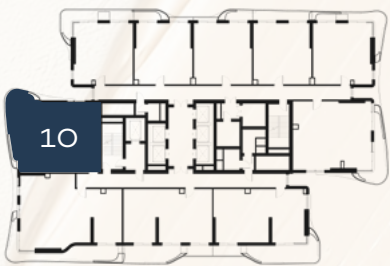

LOWER LEVEL
FLOOR 8



UPPER LEVEL
FLOOR 9



LOWER LEVEL
FLOOR 20



UPPER LEVEL
FLOOR 21

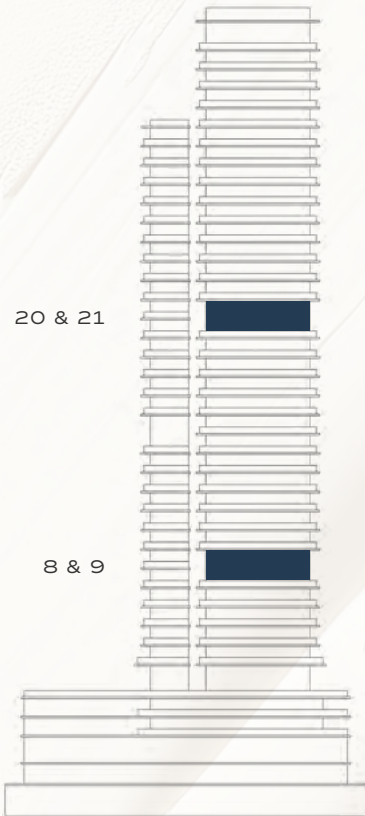

The renderings and visualisations in this brochure are for illustrative and marketing purposes only. While the information provided is accurate and reliable at the time of publication, it is important to note that only the information included in the final Sales and Purchase Agreement will carry legal significance.

BEYOND

3 BEDROOM - SIGNATURE COLLECTION

TYPE B



LOWER LEVEL



UPPER LEVEL

UNIT AREAS

INTERNAL AREA	2,337 - 2,339	SQ.FT
EXTERNAL AREA	384 - 458	SQ.FT
TOTAL AREA	2,722 - 2,797	SQ.FT

KEY SECTION



LOWER LEVEL
FLOOR 8

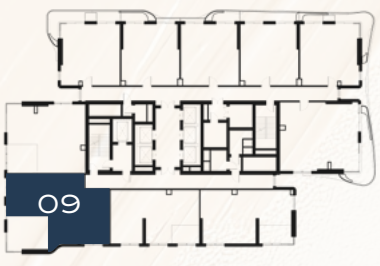

UPPER LEVEL
FLOOR 9

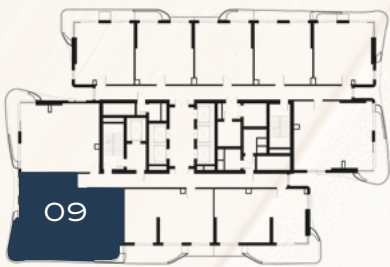

LOWER LEVEL
FLOOR 20



UPPER LEVEL
FLOOR 21

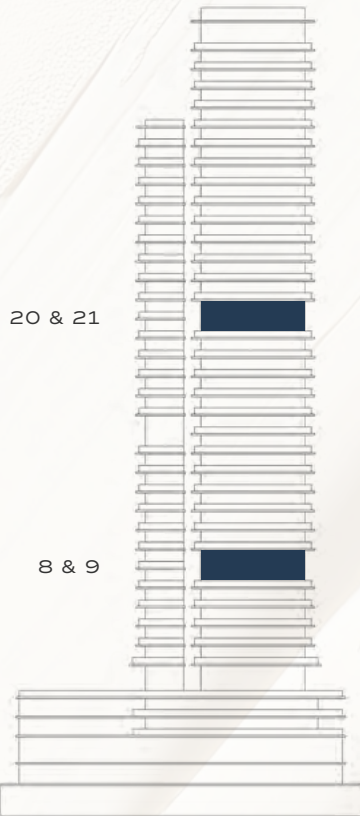

The renderings and visualisations in this brochure are for illustrative and marketing purposes only. While the information provided is accurate and reliable at the time of publication, it is important to note that only the information included in the final Sales and Purchase Agreement will carry legal significance.

3 BEDROOM - SIGNATURE COLLECTION

TYPE C



LOWER LEVEL



UPPER LEVEL



INTERNAL AREA	1,743	SQ.FT
EXTERNAL AREA	281 - 335	SQ.FT
TOTAL AREA	2,024 - 2,079	SQ.FT



LOWER LEVEL
FLOOR 8

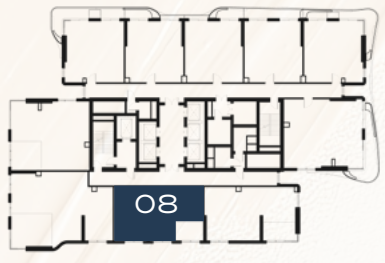

UPPER LEVEL
FLOOR 9



LOWER LEVEL
FLOOR 20



UPPER LEVEL
FLOOR 21

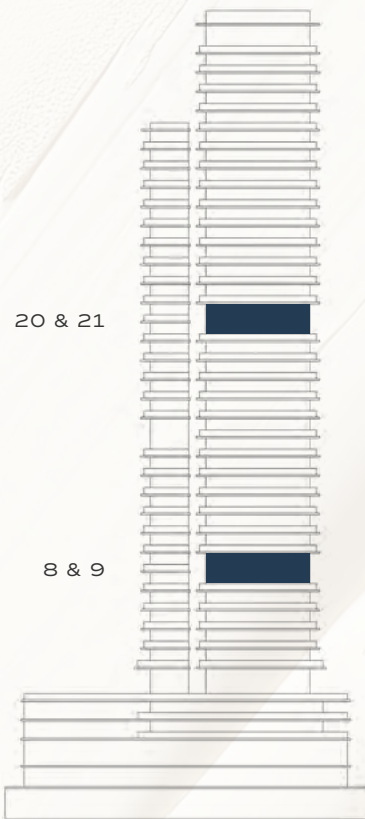

The renderings and visualisations in this brochure are for illustrative and marketing purposes only. While the information provided is accurate and reliable at the time of publication, it is important to note that only the information included in the final Sales and Purchase Agreement will carry legal significance.

3 BEDROOM - SIGNATURE COLLECTION

TYPE D



LOWER LEVEL



UPPER LEVEL

UNIT AREAS

INTERNAL AREA	1,778 - 1,779	SQ.FT
EXTERNAL AREA	367 - 427	SQ.FT
TOTAL AREA	2,146 - 2,206	SQ.FT

KEY SECTION



LOWER LEVEL
FLOOR 8



UPPER LEVEL
FLOOR 9



LOWER LEVEL
FLOOR 20



UPPER LEVEL
FLOOR 21

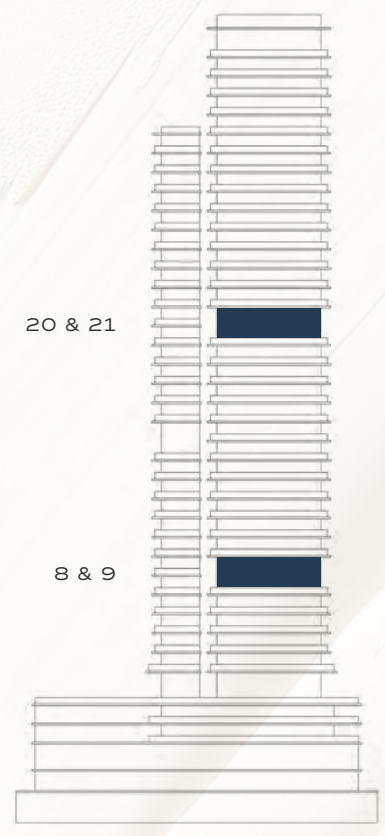

BEYOND

The renderings and visualisations in this brochure are for illustrative and marketing purposes only. While the information provided is accurate and reliable at the time of publication, it is important to note that only the information included in the final Sales and Purchase Agreement will carry legal significance.

3 BEDROOM - MASONETTE



LOWER LEVEL



UPPER LEVEL

UNIT AREAS

INTERNAL AREA	2,785 - 2,813	SQ.FT
EXTERNAL AREA	171	SQ.FT
TOTAL AREA	2,956 - 2,984	SQ.FT

KEY SECTION

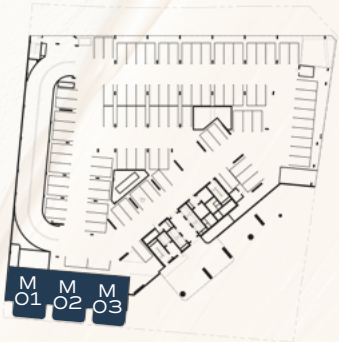

LOWER LEVEL
FLOOR 1



UPPER LEVEL
FLOOR 2



The renderings and visualisations in this brochure are for illustrative and marketing purposes only. While the information provided is accurate and reliable at the time of publication, it is important to note that only the information included in the final Sales and Purchase Agreement will carry legal significance.

4 BEDROOM - PENTHOUSE



UNIT AREAS

INTERNAL AREA	3,229	SQ.FT
EXTERNAL AREA	2,549	SQ.FT
TOTAL AREA	5,778	SQ.FT

KEY SECTION

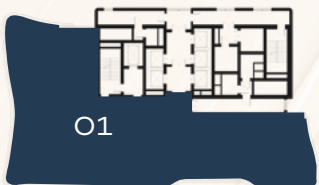

FLOOR 35



The renderings and visualisations in this brochure are for illustrative and marketing purposes only. While the information provided is accurate and reliable at the time of publication, it is important to note that only the information included in the final Sales and Purchase Agreement will carry legal significance.

An abstract painting on a textured canvas. The background is a light beige or off-white color. Overlaid on this are several broad, expressive brushstrokes. A large, sweeping stroke of deep purple or magenta dominates the upper right and center. Below and to the left of this, there are strokes of a lighter, dusty rose or pinkish-purple. In the bottom right corner, there are dark, almost black, textured strokes. The overall effect is one of organic, fluid movement and layered color.

BEYOND

BEYONDDEVELOPMENTS.AE